

3.5mm Dia. Jacks

LGY0609-0600F

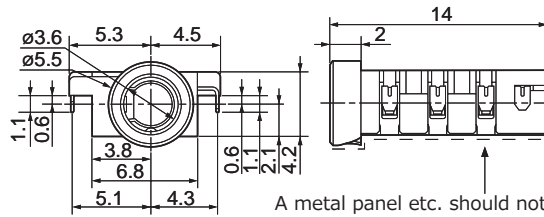

A metal panel etc. should not be installed near this area.
このエリア付近には、金属パネル等を設置しないでください。

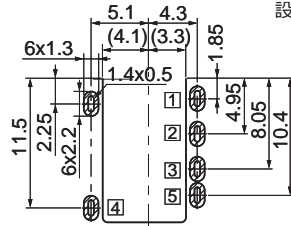

P.C. Board Dimension
取付基板参考図
(Top View)

(Land)

[t=0.8]

Circuits / 回路

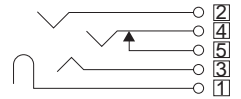

Reflow Soldering
リフローはんだ

Manual Soldering
手はんだ

Mid Mount Type