

FPC/FFC Connectors

0.5mm Pitch One Action FPC/FFC Connector : EA-51 Series

■ Features

1. One action FPC/FFC lock system suitable for robotic assembly contributes to automation of the manufacturing process.
2. Able to check the condition of FPC/FFC insertion through windows at the top of the connector. (Right angle type only)
3. Since the lever is made of SUS with high rigidity, when the FPC/FFC is pulled out by force, even if the FPC/FFC is broken, the connector itself will not be deformed or broken.
4. Compatible with FPC, FFC, and shielded FPC. (Applicable thickness : Signal 0.3mm/Ground 0.5mm)
5. Pin count : Right Angle Type 20, 25, 30, Vertical Type 25.

■ Specifications

- Pitch : 0.5mm
- Number of Pins : 20,25,30 (Right angle type), 25 (Vertical type)
- Contact : Lower Contact (Right angle type), One-sided (Vertical type)
- Mounting Height : 3.2mm (Right angle type), 6.35mm (Vertical type)
- Applicable FPC Thickness : 0.3mm (Signal), 0.5mm (Ground)
- FPC Connection : Non-ZIF
- Rating : 50V AC/DC, 0.4A
- Contact Resistance : 40mΩ max.
- Insulation Resistance : 50MΩ min. at 500V DC
- Withstanding Voltage : 500V AC (for one minute)
- Operating Temperature Range : -20°C to +80°C

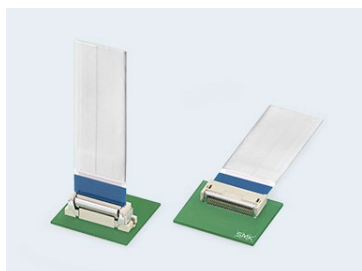

Right Angle Type : CFPC5□□-0101F

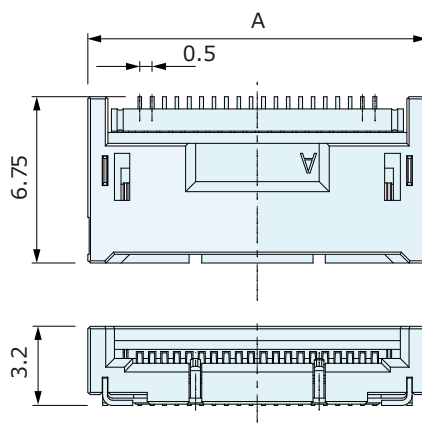

□□ No. of Pins	A
20	13.7
25	16.2
30	18.7

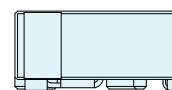

Vertical Type : CFPC725-0101F

